

STEP 1

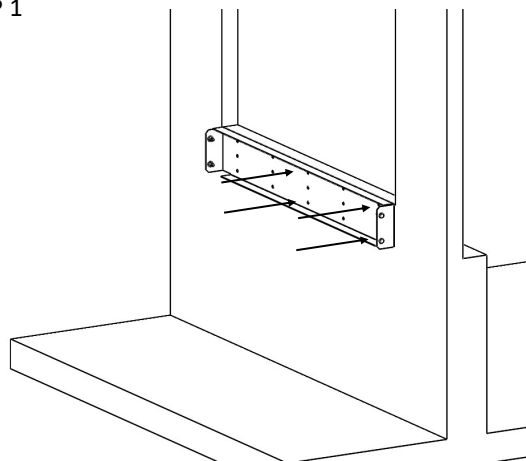

Place the wall support part at the base of the opening, centred on it with the appropriate screws for the support, in sufficient quantity.

STEP 2

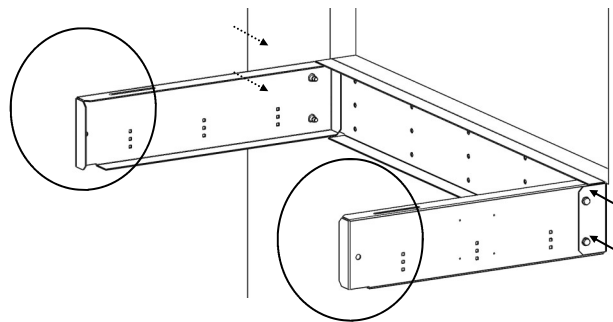

The two lateral symmetrical supports are fixed by 4 M8x16 screws with flat washers and grower, to respect the direction of the openings, and to tighten, not thoroughly at once.

STEP 3

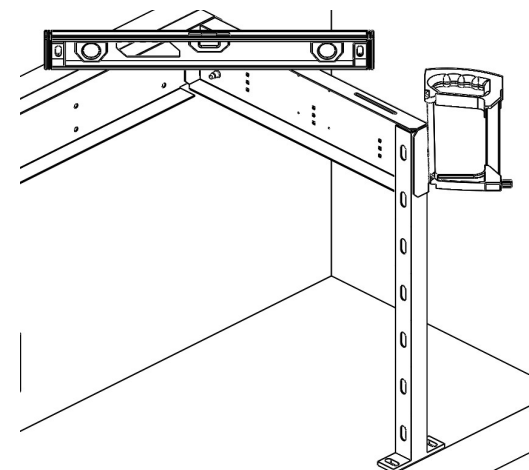

Being levelled, position the SIKLA foot and cut it with a hacksaw if necessary. To take it out. Make sure the soil is solid, otherwise add a suitable late.

STEP 4

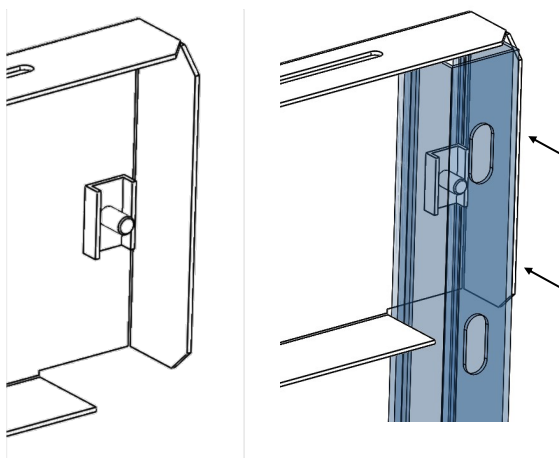

Insert the SIKLA screw and aim the special nut, position it vertically. Put back the foot, level the surface and tighten the 3 screws. Same thing on the other side.

STEP 5

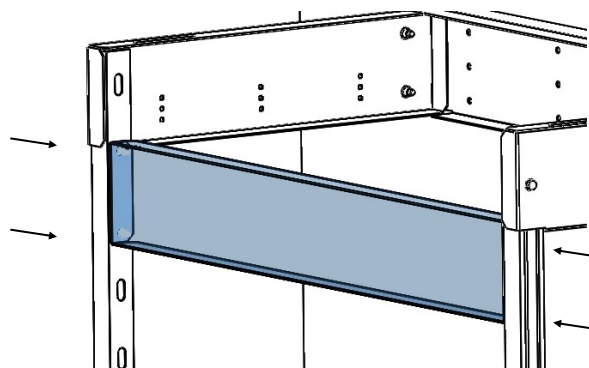

Fit the last piece, secure it with 4 screws M8x16 + flat and grower washers. The highest position makes it possible to square well together. Tighten

STEP 6

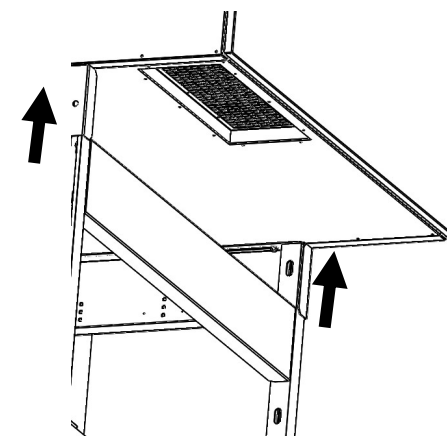

Slide the unit onto the base and secure it on both sides with 2 M6 screws + washers.